



motorola



USER'S GUIDE

Dashboard Camera

Model: MDC100

The features described in this user's guide are subject to modifications without prior notice.

Welcome...

to your new Motorola Dashboard Camera!

Thank you for purchasing the Dashboard Camera.

Please keep your original dated sales receipt for your records. For warranty service of your Motorola product, you will need to provide a copy of your dated sales receipt to confirm warranty status.

Registration is not required for warranty coverage.

For product related questions, please call:

US and Canada 1-888-331-3383

E-mail: support@motorolastore.com

On the Web: www.motorolastore.com/support

This User's Guide has all the information you need to make the most out of your product.

Please read the Safety Instructions on page 5 before you install the unit.

Before you use the Dashboard Camera, we recommend you insert a SD card into the SD card slot.

Got everything?

- Dashboard Camera
- Windshield Mount
- Charging Cable
- Car Adapter
- User Manual

Overview of your Dashboard Camera

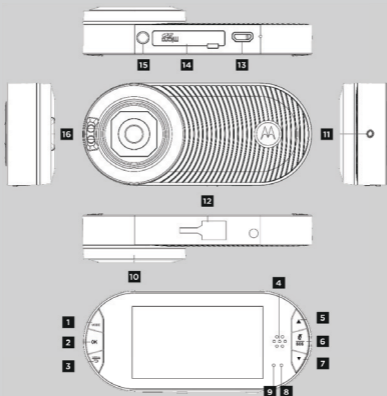

- | | |
|--|------------------------------------|
| 1. Video/Photo/Replay mode switcher | 11. Reset button |
| 2. OK/Enter button | 12. Mount socket |
| 3. Menu/Back button | 13. USB/Power socket |
| 4. Speaker | 14. Memory card slot |
| 5. Up arrow ▲ | 15. Short press when OFF: Power ON |
| 6. Short press: Mute
Long press: SOS mode | Short press when ON: LED switch |
| 7. Down arrow ▼ | Long press when ON: Power OFF |
| 8. Status LED | |
| 9. Power LED | |
| 10. Lens | 16. LED lights |



Table of contents

1.	Safety Instructions.....	5
2.	Getting Started	6
2.1	Installing your device	6
2.2	First use.....	7
3.	Using your dashboard camera.....	8
3.1	Switching modes.....	9
3.2	Video recording mode	10
3.3	Photo shooting mode	10
3.4	Replay mode	11
3.5	Parking mode	11
3.6	SOS mode	12
3.7	Motion detection	12
4.	Settings.....	13
4.1	Main Settings	13
4.2	Video Settings	16
4.3	Photo Settings	19
4.4	Playback settings.....	21
5.	General Information.....	23
6.	Technical Specifications	33



1. Safety Instructions



WARNING

- Do not install the device within the driver's or passenger airbag operation range. Please refer to your car's service manual for details about the operation range of your car's airbags.
- Never modify modes, settings or program your device while your car is in motion.
- Ensure the device and its power cord are installed as per instructed on page 6 and do not obstruct the driver's line of sight or impede the operation of any driving controls.

Before using the dash cam, the user shall check the applicable laws on the use of dash cams.

In some jurisdictions, the use of dash cams can be considered as an invasion of privacy. Furthermore, the mounting of the dash cam on the windshield might be regulated by law in some jurisdictions.

It is the user's responsibility to check the applicable laws before using the dash cam. We do not take any responsibility for wrong or unlawful use of the dash cam.

2. Getting Started

2.1 Installing your device

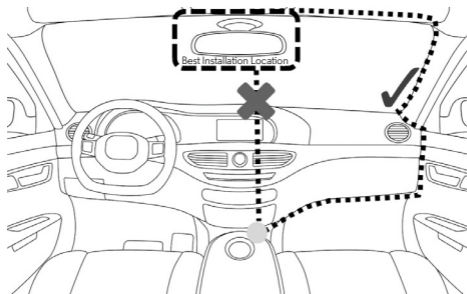

- Install your device within the rear-view mirror area and within the wiper cleaning area to get the clearest possible view.
- Your device comes with a 3.6m USB power cable, organize the power cord so that it doesn't interfere with the driver's vision, use cable clips to secure the power cord if necessary.
- Place the device on the windshield mount first. Press the suction cup of the mount to the windshield and turn the knob clockwise to lock. Ensure the mount is safely attached to the windshield.



- When using the dashboard camera device in your car, we recommend that you always use the cigarette charger in order to maintain the battery level. The unit is not designed to be run on battery power alone, the battery is there for backup purposes only.

2.2 First use

- Your device is equipped with a SD card slot, however the SD card itself is not provided with this dashboard camera.
- Insert a SD card in the SD card slot. Your dashboard camera accepts SD cards of up to 32GB capacity (class 10). It is recommended that you format the SD card, please to the settings described in this manual.
- Your dashboard camera will always power up and begin recording automatically as soon as it is connected to a power source. Simply connect your dashboard camera to a power source that comes on when you start the engine of your vehicle, and dashboard camera will start recording automatically without you having to remember to press on a button.
- You can also power it ON or OFF manually by pressing the power button. The power LED (Red) will turn ON when the power is ON. Whenever the device is turned ON or OFF you will see a splash screen showing the Motorola logo.



3. *Using your dashboard camera*

- The purpose of your dashboard camera is to continuously record the road ahead and to automatically record and save any incidents or accidents you might be involved in. The status LED (Blue) will flash when it is recording.
- Your device records video by clusters of up to 3 minutes, the duration can be changed in the video settings, see **4.2 Video Settings**. It is equipped with a sensor that detects shocks. Each time a shock is detected, it will save to the SD card the cluster during which the event occurred. The sensitivity of the sensor can be changed in the video settings screen, see section 4.
- Once the memory of your SD card is full, it will automatically overwrite the oldest footages in which no event has been detected. Your dashboard camera will save a maximum of 20 sensor triggered footages. When it reaches 20, it will start deleting old recorded footages on a first in first out basis. The actual number of files that can be recorded depends on the SD card capacity.



3.1 Switching modes

Your dash camera has 3 main modes for recording and viewing:

Video recording	Main function and default mode for video recording.
Photo shooting	Allows you to capture still photographs to your SD card.
Replay	Allows you to view or delete saved footages or photographs. You can also connect the device to your computer using the supplied USB cable to view and manage photos and videos stored inside the SD card.

While in video recording mode, press the **OK** button to stop video recording then press the **MODE** button to switch to photo mode. Press the **MODE** button once again to switch to replay mode. Pressing the **MODE** button once more will take you back to the video recording mode.

IMPORTANT!

The driver must never switch modes while the car is in motion.



3.2 Video recording mode

Video recording will start automatically when the device is powered on. You can manually turn video recording off by pressing the **OK** button. Press the **OK** button once again to restart video recording. The status LED (Blue) will flash when the device is recording.

Please refer to **4.2 Video Settings** for detailed description of the settings menu.

IMPORTANT!

If video recording is manually turned off, the sensor will stop detecting shocks and no video will be saved to the SD card.

3.3 Photo shooting mode

While in video recording mode, press the **OK** button to stop video recording then press the **MODE** button to switch to photo mode.

Press the **OK** button to take a photo, it will be saved to the SD card. Please refer to **4.3 Photo Settings** for detailed description of the settings menu.



3.4 Replay mode

While in video recording mode, press the **OK** button to stop video recording then press the **MODE** button twice to switch to photo mode.

You can browse your photos and videos using the ▲ and ▼ buttons. To view a stored video, navigate to the desired video. Use the **OK** button to play or stop the video.

Use the ▲ and ▼ buttons to rewind or fast forward the video.

Please refer to **4.4 Playback settings** for detailed description of the settings menu.

3.5 Parking mode

Your dashboard camera can record footages of events occurring when your car is parked with its engine off. The built-in battery will keep the sensor of your device in stand-by mode and will start recording automatically for 30 seconds if it detects vibrations or a shock. The parking mode can only record and save footage after an event has been detected by the sensor.

IMPORTANT!

*Due to technical reasons the Parking mode must be disabled by default. You can enable it in the video settings, see **4.2 Video Settings**.*

3.6 SOS mode

In case of emergency you can trigger the SOS mode by long pressing on the **Mute/SOS** button . When enabled, the SOS mode will save the footage current recording cluster.

3.7 Motion detection

To save memory on your SD card, you can enable motion detection. When enabled, the device will stop recording when it does not detect motion for more than 10 seconds.

IMPORTANT!

This option is disabled by default, enabling it might cause the camera not to record or save part of an incident or accident you might be involved in.

4. Settings

IMPORTANT!

After exiting the settings screen, video recording will not restart automatically. Press the **OK** button to start recording.

4.1 Main Settings



To access main settings while in video mode, press the **OK** button to stop video recording then press the **Menu/Back** button  twice.

For each sub-menu, press **▲** or **▼** to navigate, **OK** to confirm and **Menu/Back**  to go back or cancel.

Menu	Description
Date/Time	Set the date and time. Press ▲ or ▼ to set each value, press OK to switch to the next value.



Auto power off	This option is useful to save battery when the device is used in Parking mode. This is the time the device will stay On while on battery power. You can enable it for 1 or 3 minutes. If you select Off, the device will remain On until the battery is depleted.
Beep sound	Enable or disable beep sounds.
Language	Change the system language to English/France/Espanol/Portugues/Deutsch/Italiano/简体中文 / 繁体中文 / Russian/Japanese
Frequency	Set by default to 50Hz, you can set it to 60Hz if you reside in the USA.
LCD OFF	You can set the LCD to never turn off or turn off after 3 minutes.



Volume Setting	Set the volume of the built-in speaker to high/middle/low .
Format	Use this option to format your SD Card. <i>IMPORTANT!</i> <i>Formatting a SD card will erase all its memory contents.</i>
Default Setting	Reset all your devices settings to factory defaults.
Version	Current firmware version.



4.2 Video Settings



To access video settings while in video mode, press the **OK** button to stop video recording then press the **Menu/Back** button .

For each sub-menu, press **▲** or **▼** to navigate, **OK** to confirm and **Menu/Back**  to go back or cancel.

Menu	Description
Resolution	You can set the video resolution to 1080FHD 1920*1080, 1080P 1440*1080 or 720P 1280*720 . IMPORTANT! <i>If you want to store more photos or videos on your SD card, try reducing the resolution.</i>
Loop recording	Choose the default duration for each recording cluster: 1 Minute / 2 Minutes / 3 Minutes



Parking mode	Enable or disable the parking mode.
Exposure	You can adjust the exposure as you require. Press ▲ if you wish the videos to be clearer or ▼ if you need it to be darker.
Motion detection	Enable or disable motion detection.
Record audio	Enable or disable audio recording.
Date stamp	Enable or disable a date stamp showing on your videos.
G-Sensor sensitivity	You can change the sensitivity of the sensor. It is set to low by default but can be set to High/Middle/Low . If you turn the sensor off, your dash camera will not be able to save any footage.

IMPORTANT!

Changing the video quality and resolution settings to a lower value might reduce the amount of details you can see on your saved videos.



Resolution	Card Capacity	Recording time (minute)
1080FHD 1920*1080@25 fps	4GB	22
	8GB	45
	16GB	90
	32GB	180
1080P 1440*1080@30 fps	4GB	20
	8GB	42
	16GB	85
	32GB	170
720P 1280*720@30f ps	4GB	30
	8GB	60
	16GB	120
	32GB	240



4.3 Photo Settings



Press the **Menu/Back** button $\frac{\text{MENU}}{\leftarrow}$ to access photo settings while in photo mode.

For each sub-menu, press \blacktriangle or \blacktriangledown to navigate, **OK** to confirm and **Menu/Back** $\frac{\text{MENU}}{\leftarrow}$ to go back or cancel.

Menu	Description
Resolution	You can set the photo resolution to 12M pixels (4000*3000) , 8M pixels (3264*2448) or 5M pixels (2592*1944) IMPORTANT! <i>If you want to store more photos or videos on your SD card, try reducing the resolution.</i>
Quality	You can set the photo quality to Fine , Normal or Economy .



White Balance	You can set the white balance to Auto, Daylight, Cloudy, Tungsten or Fluorescent . We recommend to leave it on Auto .
Exposure	You can adjust the exposure as you require. Press ▲ if you wish the photos to be clearer or ▼ if you need it to be darker.
Date stamp	Enable or disable a date only stamp or a date+time stamp showing on your photos.

IMPORTANT!

Changing the photo quality and resolution settings to a lower value might reduce the amount of details you can see on your saved photos.



4.4 Playback settings

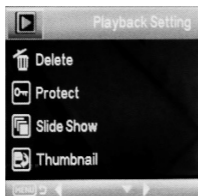

Press the **Menu/Back** button $\frac{\text{MENU}}{\leftarrow}$ to access playback settings while in playback mode.

For each sub-menu, press \blacktriangle or \blacktriangledown to navigate, **OK** to confirm and **Menu/Back** $\frac{\text{MENU}}{\leftarrow}$ to go back or cancel.

Menu	Description
Delete	Use this option to delete photos and videos stored in your SD card. You can choose between deleting the current file you are currently watching or all files on your SD card. IMPORTANT! <i>You cannot recover a photo or video that has been previously deleted.</i>



Protect	Use this option to lock photos and videos stored in your SD card so they cannot be deleted. Use the same option to unlock previously locked photos or videos. You can choose between Lock Current , Unlock Current , Lock All or Unlock All .
Slide Show	Create a slide show for your photos. You can choose between 2 Seconds , 5 Seconds or 8 Seconds interval between photos.
Thumbnail	Enable or disable thumbnail view for your stored files.



5. General Information

If your product is not working properly....

1. Read this User's Guide.
2. Visit our website: [www.motorolastore.com/
support](http://www.motorolastore.com/support)
3. Contact Customer Service at
US and Canada 1-888-331-3383
E-mail: support@motorolastore.com

Consumer Products and Accessories Limited Warranty ("Warranty")

Thank you for purchasing this Motorola branded product manufactured under license by Binatone Electronics International Ltd ("BINATONE").

What Does this Warranty Cover?

Subject to the exclusions contained below, BINATONE warrants that this Motorola branded product ("Product") or certified accessory ("Accessory") sold for use with this product is manufactured to be free from defects in materials and workmanship under normal consumer usage for the period outlined below. This Warranty is your exclusive warranty and is not transferable.



THIS WARRANTY GIVES YOU SPECIFIC LEGAL RIGHTS, AND YOU MAY HAVE OTHER RIGHTS THAT VARY BY STATE, PROVINCE OR COUNTRY. FOR CONSUMERS WHO ARE COVERED BY CONSUMER PROTECTION LAWS OR REGULATIONS IN THEIR COUNTRY OF PURCHASE OR, IF DIFFERENT, THEIR COUNTRY OF RESIDENCE, THE BENEFITS CONFERRED BY THIS LIMITED WARRANTY ARE IN ADDITION TO ALL RIGHTS AND REMEDIES CONVEYED BY SUCH CONSUMER PROTECTION LAWS AND REGULATIONS. FOR A FULL UNDERSTANDING OF YOUR RIGHTS YOU SHOULD CONSULT THE LAWS OF YOUR COUNTRY, PROVINCE OR STATE.

Who is covered?

This Warranty extends only to the first consumer purchaser, and is not transferable.

What will BINATONE do?

BINATONE or its authorized distributor at its option and within a commercially reasonable time, will at no charge repair or replace any Products or Accessories that does not conform to this Warranty. We may use functionally equivalent reconditioned/ refurbished/ pre-owned or new Products, Accessories or parts.



What Other Limitations Are There?

ANY IMPLIED WARRANTIES, INCLUDING WITHOUT LIMITATION THE IMPLIED WARRANTIES OF MERCHANTABILITY AND FITNESS FOR A PARTICULAR PURPOSE, SHALL BE LIMITED TO THE DURATION OF THIS LIMITED WARRANTY, OTHERWISE THE REPAIR OR REPLACEMENT PROVIDED UNDER THIS EXPRESS LIMITED WARRANTY IS THE EXCLUSIVE REMEDY OF THE CONSUMER, AND IS PROVIDED IN LIEU OF ALL OTHER WARRANTIES, EXPRESS OR IMPLIED. IN NO EVENT SHALL MOTOROLA OR BINATONE BE LIABLE, WHETHER IN CONTRACT OR TORT (INCLUDING NEGLIGENCE) FOR DAMAGES IN EXCESS OF THE PURCHASE PRICE OF THE PRODUCT OR ACCESSORY, OR FOR ANY INDIRECT, INCIDENTAL, SPECIAL OR CONSEQUENTIAL DAMAGES OF ANY KIND, OR LOSS OF REVENUE OR PROFITS, LOSS OF BUSINESS, LOSS OF INFORMATION OR OTHER FINANCIAL LOSS ARISING OUT OF OR IN CONNECTION WITH THE ABILITY OR INABILITY TO USE THE PRODUCTS OR ACCESSORIES TO THE FULL EXTENT THESE DAMAGES MAY BE DISCLAIMED BY LAW.

Some jurisdictions do not allow the limitation or

exclusion of incidental or consequential damages, or limitation on the length of an implied warranty, so the above limitations or exclusions may not apply to you. This Warranty gives you specific legal rights, and you may also have other rights that vary from one jurisdiction to another.

Products Covered	Length of Coverage
Consumer Products	One (1) year from the date of the Products, original purchase by the first consumer purchaser of the product.
Consumer Accessories	Ninety (90) days from the date of the Accessories, original purchase by the first consumer purchaser of the product.
Consumer Products and Accessories that are Repaired or Replaced	The balance of the original warranty or for Ninety (90) days from the date returned to the consumer, whichever is longer.

Exclusions

Normal Wear and Tear. Periodic maintenance, repair and replacement of parts due to normal wear



and tear are excluded from coverage.

Batteries. Only batteries whose fully charged capacity falls below 80% of their rated capacity and batteries that leak are covered by this Warranty.

Abuse & Misuse. Defects or damage that result from: (a) improper operation, storage, misuse or abuse, accident or neglect, such as physical damage (cracks, scratches, etc.) to the surface of the product resulting from misuse; (b) contact with liquid, water, rain, extreme humidity or heavy perspiration, sand, dirt or the like, extreme heat, or food; (c) use of the Products or Accessories for commercial purposes or subjecting the Product or Accessory to abnormal usage or conditions; or (d) other acts which are not the fault of MOTOROLA or BINATONE, are excluded from coverage.

Use of Non-Motorola branded Products and Accessories. Defects or damage that result from the use of Non-Motorola branded or certified Products or Accessories or other peripheral equipment are excluded from coverage.

Unauthorized Service or Modification. Defects or damages resulting from service, testing, adjustment, installation, maintenance, alteration, or modification in any way by someone other than MOTOROLA, BINATONE or its authorized service centers, are

excluded from coverage.

Altered Products. Products or Accessories with (a) serial numbers or date tags that have been removed, altered or obliterated; (b) broken seals or that show evidence of tampering; (c) mismatched board serial numbers; or (d) nonconforming or non-Motorola branded housings, or parts, are excluded from coverage.

Communication Services. Defects, damages, or the failure of Products or Accessories due to any communication service or signal you may subscribe to or use with the Products or Accessories is excluded from coverage.

How to Obtain Warranty Service or Other Information?

To obtain service or information, please call:

US and Canada 1-888-331-3383

E-mail: support@motorolastore.com

You will receive instructions on how to ship the Products or Accessories at your expense and risk, to a BINATONE Authorized Repair Center.

To obtain service, you must include: (a) the Product or Accessory; (b) the original proof of purchase (receipt) which includes the date, place and seller of



the Product; (c) if a warranty card was included in your box, a completed warranty card showing the serial number of the Product; (d) a written description of the problem; and, most importantly; (e) your address and telephone number.

These terms and conditions constitute the complete warranty agreement between you and BINATONE regarding the Products or Accessories purchased by you, and supersede any prior agreement or representations, including representations made in any literature publications or promotional materials issued by BINATONE or representations made by any agent employee or staff of BINATONE, that may have been made in connection with the said purchase.

FCC and IC regulations

FCC Part 15

NOTE: This equipment has been tested and found to comply with the limits for a Class B digital device, pursuant to Part 15 of the Federal Communications Commission (FCC) rules. These limits are designed to provide reasonable protection against harmful interference in a residential installation. This equipment generates, uses and can radiate radio frequency energy and, if not installed and used in accordance with the instructions, may cause harmful



interference to radio communications. However, there is no guarantee that interference will not occur in a particular installation. If this equipment does cause harmful interference to radio or television reception, which can be determined by turning the equipment off and on, the user is encouraged to try to correct the interference by one or more of the following measures:

- Reorient or relocate the receiving antenna.
- Increase the separation between the equipment and receiver.
- Connect the equipment into an outlet on a circuit different from that to which the receiver is connected.
- Consult the dealer or an experienced radio/TV technician for help.

Changes or modifications to this equipment not expressly approved by the party responsible for compliance could void the user's authority to operate the equipment.

This device complies with Part 15 of the FCC rules. Operation is subject to the following two conditions: (1) this device may not cause harmful interference, and (2) this device must accept any interference received, including interference that may cause undesired operation. Privacy of communications



may not be ensured when using this device.

To ensure safety of users, the FCC has established criteria for the amount of radio frequency energy that can be safely absorbed by a user or bystander according to the intended usage of the product. This product has been tested and found to comply with the FCC criteria. This Class B digital apparatus complies with Canadian ICES-003.

CAN ICES-3(B)/NMB-3(B)

WARNING

Changes or modifications, to this equipment not expressly approved by the party responsible for compliance could void the user's authority to operate the equipment.

The socket-outlet shall be installed near the equipment and shall be easily accessible.

Industry Canada

This device complies with Industry Canada licence-exempt RSS standard(s): Operation is subject to the following Two conditions:(1) this device may not cause interference, and (2) this device must accept any interference, including interference that may cause undesired operation of the device.

The term "IC: " before the certification/registration number only signifies that the Industry Canada



technical specifications were met. This product meets the applicable Industry Canada technical specifications.

Le présent appareil est conforme aux CNR d'Industrie Canada applicables aux appareils radio exempts de licence. L'exploitation est autorisée aux deux conditions suivantes : (1) l'appareil ne doit pas produire de brouillage, et (2) l'utilisateur de l'appareil doit accepter tout brouillage radioélectrique subi, même si le brouillage est susceptible d'en compromettre le fonctionnement.



6. Technical Specifications

LCD screen	2.7-inch
Video resolution	Up to FHD 1080P
Lens	120° wide angle
Video format	AVI
Pictures resolution	Up to 12M pixels (4000x3000)
Photo format	JPEG
Micro SD card	Up to 32G capacity, Class 10
Night vision	Supported
Mic and Speaker	Built-in
Power	5V DC
Battery	Li-polymer battery
Device Dimensions	104x48x23.1mm
Mount Dimensions	85x58x30mm
Supported operating system for file viewing	Windows XP and later, MAC OS



motorola

Manufactured, distributed or sold by Binatone Electronics International LTD., official licensee for this product.

MOTOROLA and the Stylized M Logo, are trademarks or registered trademarks of Motorola Trademark Holdings, LLC. and are used under license. All other trademarks are the property of their respective owners. © 2017 Motorola Mobility LLC. All rights reserved.



US_EN Version 2.0

Printed in China