



motorola

MODEL:
MBP83SN

QUICK START GUIDE

UK EN

For a full explanation of all features and instructions, please refer to the User's Guide (available for download from www.motorolastore.com).

1. Setting up Humidifier+

1. Remove the mist lid from the top of the Humidifier and plug the mist outlet into the lid.

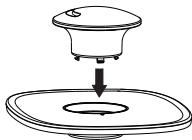

2. Lift up the handle on top of the water tank and remove the water tank from the Humidifier base.



3. Snap the handle back into place, then turn the water tank upside down, remove the tank cap and replace the tank cap by twisting it clockwise.



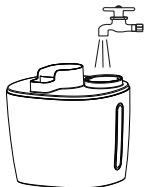

4. Fill the water tank with clean, cool water and replace the tank cap by turning it clockwise until tight.

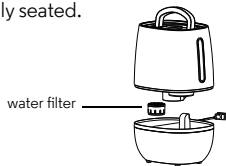

5. Install the water filter to the Humidifier base, then replace the water tank on the Humidifier base. Ensure that the water tank is firmly seated.



6. Attach the mist lid back to the Humidifier, then connect one end of the power adapter into the power port on the Humidifier and the other end to the mains power socket.

The  Mist On/Off LED will light up. Tap the Mist On/Off key  to turn mist On.

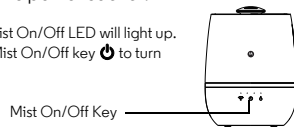

Please take note of the following minimum system requirements:

Smartphones/Tablets: Android™ and iOS® only.

Minimum requirement: iOS® 8.0, Android™ 4.4.2 or above.

For more information, please visit: [http:// hubblehome.com/requirements](http://hubblehome.com/requirements)

Install Hubble Connect for Smart Nursery App on your Android™ Devices / iPhone® / iPad®.



Download **Hubble Connect for Smart Nursery** App from the App Store for iOS devices or from the Google Play™ Store for Android™ devices.



Pair Humidifier+ with your Android™ Devices / iPhone® / iPad®.

1. Run **Hubble Connect for Smart Nursery App** on your Android™ Device / iPhone® / iPad®.
2. Ensure that your Android™ Device / iPhone® / iPad® is connected to the Wi-Fi® router.
3. Follow the in-app instructions to create your Smart Nursery Account and connect to Humidifier+ via Wi-Fi®.
4. Login to your **Hubble Connect for Smart Nursery** account, and tap on **Humidifier+** to enter Humidifier setup mode.
5. Tap on **Skip to Setup**, then tap **Next** to search for Humidifier+.
6. Tap the SSID to confirm. (For iPhone® / iPad®, exit to **Settings**, open Wi-Fi® then select the SSID of Humidifier+ from the list)
7. Tap **Next**, then **Search** to start network searching.
8. Select a Wi-Fi® network from the network list, enter Wi-Fi® password and then tap **Submit** (or **Search** for iOS device).
9. It will take a few minutes for Humidifier+ to connect to the Wi-Fi® network.
10. Tap **Get Started** when Humidifier+ is successfully connected to **Hubble Connect for Smart Nursery App**.

Note:

If you fail to complete the setup process, tap the Wi-Fi® key  on the Humidifier to enter registration mode and repeat the above steps again.

2. General Information

If your product is not working properly, read this Quick Start Guide or the User's Guide.
Contact Customer Service:

+44 (0) 844 557 0890 (UK only)*

+44 (0) 8187 62092 (ROI)

*(*Calls cost 7p per minute plus your telephone company's access charge)*

Consumer Products and Accessories Limited Warranty ("Warranty")

Thank you for purchasing this Motorola branded product manufactured under license by Binatone Electronics International LTD ("BINATONE").

What Does this Warranty Cover?

Subject to the exclusions contained below, BINATONE warrants that this Motorola branded product ("Product") or certified accessory ("Accessory") sold for use with this product that it manufactured to be free from defects in materials and workmanship under normal consumer usage for the period outlined below. This Warranty is your exclusive warranty and is not transferable.

Who is covered?

This Warranty extends only to the first consumer purchaser, and is not transferable.

What will BINATONE do?

BINATONE or its authorised distributor at its option and within a commercially reasonable time, will at no charge repair or replace any Products or Accessories that does not conform to this Warranty. We may use functionally equivalent reconditioned/ refurbished/ pre-owned or new Products, Accessories or parts.

What Other Limitations Are There?

ANY IMPLIED WARRANTIES, INCLUDING WITHOUT LIMITATION THE IMPLIED WARRANTIES OF MERCHANTABILITY AND FITNESS FOR A PARTICULAR PURPOSE, SHALL BE LIMITED TO

THE DURATION OF THIS LIMITED WARRANTY, OTHERWISE THE REPAIR OR REPLACEMENT PROVIDED UNDER THIS EXPRESS LIMITED WARRANTY IS THE EXCLUSIVE REMEDY OF THE CONSUMER, AND IS PROVIDED IN LIEU OF ALL OTHER WARRANTIES, EXPRESS OR IMPLIED. IN NO EVENT SHALL MOTOROLA OR BINATONE BE LIABLE, WHETHER IN CONTRACT OR TORT (INCLUDING NEGLIGENCE) FOR DAMAGES IN EXCESS OF THE PURCHASE PRICE OF THE PRODUCT OR ACCESSORY, OR FOR ANY INDIRECT, INCIDENTAL, SPECIAL OR CONSEQUENTIAL DAMAGES OF ANY KIND, OR LOSS OF REVENUE OR PROFITS, LOSS OF BUSINESS, LOSS OF INFORMATION OR OTHER FINANCIAL LOSS ARISING OUT OF OR IN CONNECTION WITH THE ABILITY OR INABILITY TO USE THE PRODUCTS OR ACCESSORIES TO THE FULL EXTENT THESE DAMAGES MAY BE DISCLAIMED BY LAW.

Some jurisdictions do not allow the limitation or exclusion of incidental or consequential damages, or limitation on the length of an implied warranty, so the above limitations or exclusions may not apply to you. This Warranty gives you specific legal rights, and you may also have other rights that vary from one jurisdiction to another.

Products Covered	Length of Coverage
Consumer Products	One (1) year from the date of the products original purchase by the first consumer purchaser of the product.
Consumer Accessories	Ninety (90) days from the date of the accessories original purchase by the first consumer purchaser of the product.
Consumer Products and Accessories that are Repaired or Replaced	The balance of the original warranty or for Ninety (90) days from the date returned to the consumer, whichever is longer.

Exclusions

Normal Wear and Tear. Periodic maintenance, repair and replacement of parts due to normal wear and tear are excluded from coverage.

Batteries. Only batteries whose fully charged capacity falls below 80% of their rated capacity and batteries that leak are covered by this Warranty.

Abuse & Misuse. Defects or damage that result from: (a) improper operation, storage, misuse or abuse, accident or neglect, such as physical damage (cracks, scratches, etc.) to the surface of the product resulting from misuse; (b) contact with liquid, water, rain, extreme humidity or heavy perspiration, sand, dirt or the like, extreme heat, or food; (c) use of the Products or Accessories for commercial purposes or subjecting the Product or Accessory to abnormal usage or conditions; or (d) other acts which are not the fault of MOTOROLA or BINATONE, are excluded from coverage.

Use of Non-Motorola branded Products and Accessories. Defects or damage that result from the use of Non-Motorola branded or certified Products or Accessories or other peripheral equipment are excluded from coverage.

Unauthorised Service or Modification. Defects or damages resulting from service, testing, adjustment, installation, maintenance, alteration, or modification in any way by someone other than MOTOROLA, BINATONE or its authorised service centres, are excluded from coverage.

Altered Products. Products or Accessories with (a) serial numbers or date tags that have been removed, altered or obliterated; (b) broken seals or that show evidence of tampering; (c) mismatched board serial numbers; or (d) nonconforming or non-Motorola branded housings, or parts, are excluded from coverage.

Communication Services. Defects, damages, or the failure of Products or Accessories due to any communication service or signal you may subscribe to or use with the Products or Accessories is excluded from coverage.

How to Obtain Warranty Service or Other Information?

To obtain service or information, please call:

+44 (0) 844 557 0890 (UK only)*

+44 (0) 8187 62092 (ROI)

*(*Calls cost 7p per minute plus your telephone company's access charge)*

You will receive instructions on how to ship the Products or Accessories at your expense and risk, to a BINATONE Authorised Repair Centre. To obtain service, you must include: (a) the Product or Accessory; (b) the original proof of purchase (receipt) which includes the date, place and seller of the Product; (c) if a warranty card was included in your box, a completed warranty card showing the serial number of the Product; (d) a written description of the problem; and, most importantly; (e) your address and telephone number.

These terms and conditions constitute the complete warranty agreement between you and BINATONE regarding the Products or Accessories purchased by you, and supersede any prior agreement or representations, including representations made in any literature publications or promotional materials issued by BINATONE or representations made by any agent, employee or staff of BINATONE, that may have been made in connection with the said purchase.

Disposal of the Device (Environment)

At the end of the product life cycle, you should not dispose of this product with normal household waste. Take this product to a collection point for the recycling of electrical and electronic equipment. The symbol on the product, user's guide and/or box indicates this.

Some of the product materials can be re-used if you take them to a recycling point. By reusing some parts or raw materials from used products you make an important contribution to the protection of the environment.

Please contact your local authorities in case you need more information on the collection points in your area.



CE DECLARATION

This product is in compliance with the essential requirements and other relevant provisions of the R&TTE directive 1999/5/EC.

Download User Guide from website: www.motorolastore.com



Manufactured, distributed or sold by Binatone Electronics International LTD., official licensee for this product. MOTOROLA and the Stylised M logo are trademarks or registered trademarks of Motorola Trademark Holdings, LLC. and are used under license. Apple logo is a trademark of Apple Inc., registered in the U.S. and other countries. App Store is a service mark of Apple Inc. Google Play and Android are trademarks of Google Inc. Wi-Fi is a trademark of the Wi-Fi Alliance. All other trademarks are the property of their respective owners. © 2016 Motorola Mobility LLC. All rights reserved.



Printed in China
UK_EN Version 1.0