



motorola

UK EN

QUICK START GUIDE

For a full explanation of all features and instructions, please refer to the User's Guide.

1. Setting up your Digital Audio Baby Monitor

MODELS:
MBP160
MBP160-2

A. Baby unit power supply

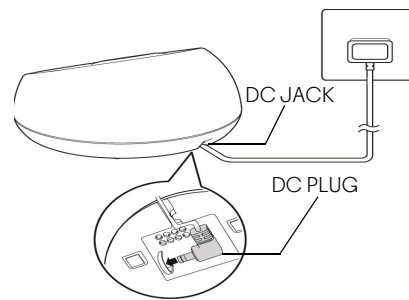

1. Insert the DC plug of the power adapter with the bigger DC plug into the DC jack on the back of the baby unit, as shown.
2. Connect the other end of the power adapter to a suitable mains power.

B. Parent unit battery installation and power supply

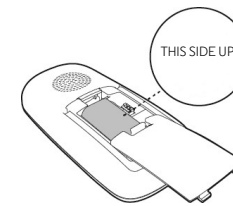

The rechargeable battery pack supplied should be installed so that the Parent Unit can be moved without losing the link with the Baby Unit(s). Charge the parent unit before using it for the first time or when the parent unit indicates that battery is low.

1. Slide off the battery compartment cover.
2. Insert the plug of the rechargeable battery pack into the jack inside the battery compartment.
3. Fit the battery pack into the compartment, with the label THIS SIDE UP facing up.
4. Slide the battery compartment cover back until it clicks into place.
5. Insert the DC plug of the power adapter with the smaller DC plug into the DC jack on the side of the parent unit.
6. Connect the other end of the power adapter to a suitable mains power.
7. The charging indicator comes on.

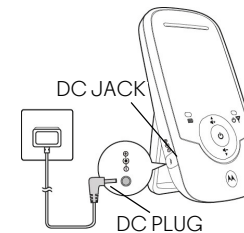

C. Desktop stand on parent unit

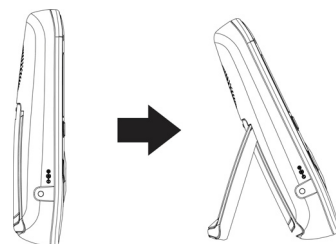

The parent unit comes with a desktop stand attached to the back of the unit. To place the parent unit on a desk, simply pull out the stand, as shown.

NOTE

Place the parent unit on a flat, even surface.

! WARNING:

Strangulation Hazard. Children have STRANGLED in cords. Keep this cord out of the reach of children (more than 1m away). Never use extension cords with AC Adapters. Only use the AC Adapters provided.

2. Troubleshooting

Power/Link Indicator on the parent unit does not come on

- Check whether the parent unit is powered on.
- Check whether the supplied battery pack is correctly installed and that they are not drained.
- Recharge the parent unit by connecting it to the mains power.

Power/Link Indicator on the baby unit flashes

- The parent unit and the baby unit may be out of range with each other. Reduce the distance between the units, but not closer than 1 metre.
- The baby unit may be powered off. Press and hold  to power on the baby unit.

Charging Indicator on the parent unit screen flashes

- Battery pack in the parent unit is running low. Connect the parent unit to the mains power with the supplied power adapter for recharging.

The parent unit beeps

- The parent unit may have lost connection with the baby unit. Reduce the distance between the parent unit and the baby unit, but not closer than 1 metre.
- The baby unit may be powered off. Press and hold  to power on the baby unit.
- Battery pack in the parent unit is running low. Connect the parent unit to the mains power with the supplied power adapter for recharging.

Cannot hear sound or baby cry from the parent unit

- The volume level in the parent unit may be set too low, increase the volume level of the parent unit.
- The parent unit and the baby unit may be out of range with each other. Reduce the distance between the units, but not closer than 1 metre.

The digital baby monitor system produces a high-pitched noise

- The parent unit and the baby unit are too close to each other. Make sure that the parent unit and baby unit are at least 1 metre away from each other.
- The speaker volume of the parent unit may be set too high. Decrease the volume of the parent unit.

Battery pack in the parent unit is running low quickly

- The volume level of the parent unit may be set too high, which consumes power. Decrease the volume level of the parent unit.

3. General Information

If your product is not working properly...

1. Read this Quick Start Guide or the User's Guide.
2. Visit our website: www.motorola.com
3. Contact Customer Service:

+44 (0) 844 557 0890 (UK only)

+44 (0) 8187 62092 (ROI)



Manufactured, distributed or sold by Binatone Electronics International LTD., official licensee for this product. MOTOROLA and the Stylised M Logo, are trademarks or registered trademarks of Motorola Trademark Holdings, LLC. and are used under license. All other trademarks are the property of their respective owners. © 2015 Motorola Mobility LLC. All rights reserved.



Printed in China
UK_EN Version 5.0